

## 4. Options

### Privacy Handset:

1. The Privacy Handset Kit is ordered separately.
2. Mount the handset cup to the mounting plate.
3. Mount the spacer plate and the mounting bracket, by using the longer screws provided with the kit. (re-installed the RAM arm-bracket behind these plates).
4. Connect the Privacy Handset 3.5mm plug into the rear cable jack.
5. Privacy Handset mode is active whenever the handset is removed from the cup.



### Earpiece-Jack Mode:

Use a 2.5mm earpiece plugged into the right side of the 9555 handset.

1. During a Bluetooth® call, to enable Earpiece-Jack Mode, press and hold the Mute button for 1.5 seconds. The LED flashes **ORANGE**.
2. To exit Earpiece-Jack Mode and revert to Bluetooth®, press the Mute button once.

## 5. Add Bluetooth® Device (optional)

**AUDIO:** To configure (pair) to a Bluetooth® headset device:

1. Discovery Mode: **Press and hold for 5 secs** the Bluetooth® button on the cradle. The LED flashes **BLUE** and **ORANGE**.





2. Hold the Headset device button(s) to enter pairing mode.
3. Once paired, the Bluetooth® LED is **BLUE** (half intensity).
4. Bluetooth® can be turned ON with a **single press**, and OFF by **press for 2 secs** the Bluetooth® button on the cradle.

## 6. Using IntelliDOCK 9555

- After applying power to AC power adaptor or turning key/Acc on, the IntelliDOCK will beep upon power up
- Wait for phone to power up and register

### PANEL BUTTONS AND INDICATORS:

LOCATION	BUTTON MODE	LED/SOUND
	Out of Call: Toggle Ringer Mode	LED off. Ringer choice sounds as preview.
	During In-Call Bluetooth: Mute (single press)	LED is <b>RED</b> when MUTE.
	During In-Call Bluetooth: Earpiece-jack (1.5 seconds press)  Subsequent single press, exits Earpiece-jack	LED flashes <b>ORANGE</b> .
	Bluetooth® On (single press)	LED is <b>BLUE</b> (half intensity) when Bluetooth® ON and is paired. Fast flashing when searching device. Slow flashing during a call.
	Bluetooth® OFF (1.5 seconds press)	Single beep sounds when turning OFF.
	Discovery Mode (5 seconds press)	LED flashes <b>ORANGE</b> and <b>BLUE</b> . Ringer sounds double (2) beeps.
	Clear Bluetooth® Devices (10 seconds press)	Ringer sounds triple (3) beeps.



www.beamcommunications.com  
info@beamcommunications.com  
TEL: +61 3 8588 4500  
FAX: +61 3 9560 9055



## QUICK START GUIDE

### iridium IntelliDOCK 9555



Suitable for the Iridium 9555  
Portable Satellite Telephone

Beam Communications Pty Ltd

USR0SG004802

# 1. Installing IntelliDOCK Cradle



- Considerations:**
- Affix the base plate in a location that allows easy access & does not obstruct driver
  - Allow sufficient room to easily run cables from the IntelliDOCK
  - ONLY use the M4 screws (supplied) to affix the base to the IntelliDOCK to avoid any damage
  - For wall mounting use the RAM Bracket with both bases parallel to each other
  - Tighten wing nut on the bracket to securely hold the IntelliDOCK
  - Avoid making any sharp bends in the antenna cable when determining the cable route
  - The fixed cables from the IntelliDOCK should never be extended, Antenna cables must be approved

**WARNING:** Your Iridium 9555 Handset requires firmware HT09007 or greater. To check your firmware version on your Iridium 9555 handset press "Menu" then navigate to "Setup" then "Phone Information". For more information and 9555 Handset firmware downloads visit: <http://www.beamcommunications.com/support/intelldock9555>

**NOTE:** For Data operation the USB port on the Iridium 9555 handset must not be used whilst docked in the cradle. Please use the USB port located on the bottom of the 9555 cradle.

# IntelliDOCK 9555 Installation Set Up

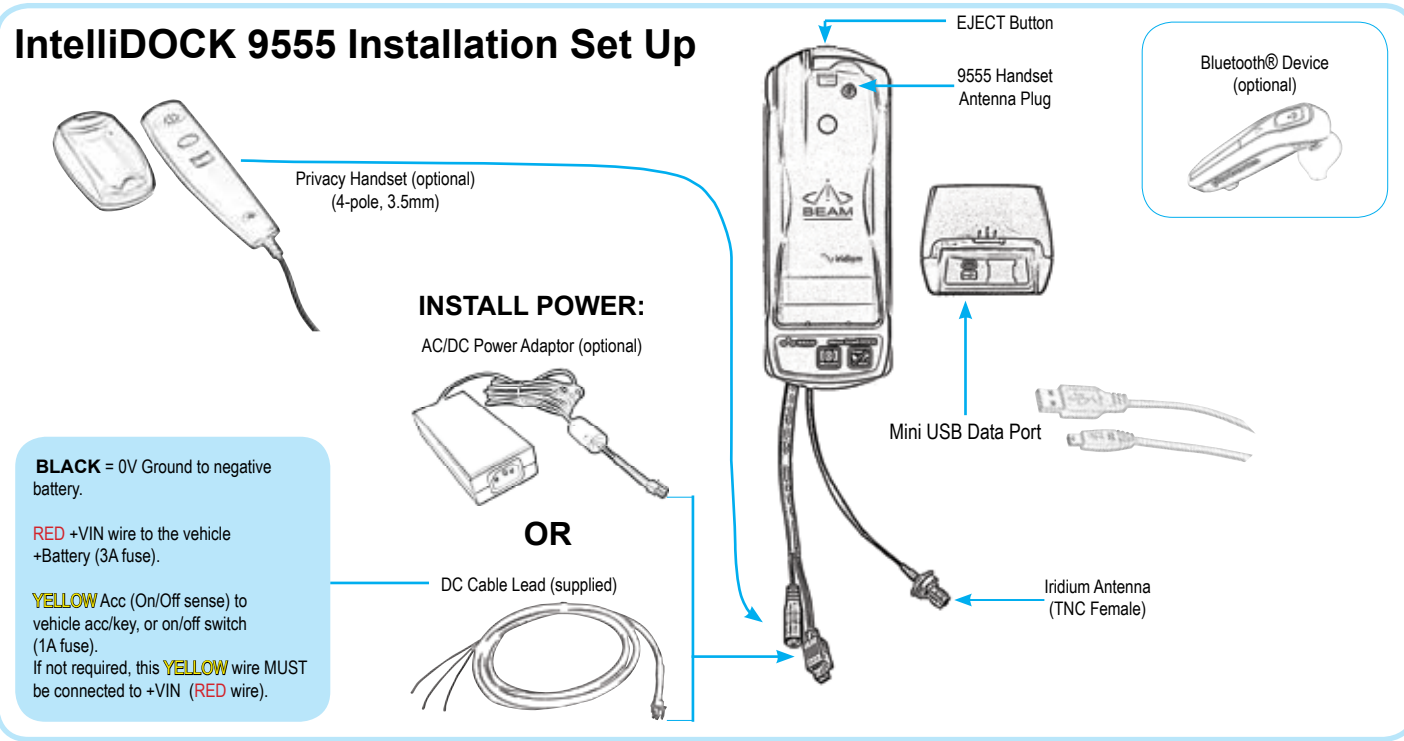

# 2. Installation

- DO NOT route cables near areas of intense heat
- DO NOT pull or strain the cables from the IntelliDOCK

## Connecting to Power:

- Connect DC Cable Lead or optional AC Power Adaptor
- The IntelliDOCK can be connected to a 9-32V DC input > 25 watts

## Connecting to the Antenna:

- The IntelliDOCK has a fixed antenna fly lead ready for connecting to antenna cable for Iridium.
- Only certified cable within the Iridium specification should be used
- Ensure antenna cable is routed avoiding any sharp bends in the cable
- The antenna should always be installed with clear line of site to the sky

## IntelliDOCK USB Data Port:

- The IntelliDOCK has an integrated USB Data Port on the rear. Drivers for this USB port can be download from <http://www.beamcommunications.com/support/intelldock9555>

# 3. Inserting & Ejecting 9555 Handset

## Inserting:

- Remove rubber grommet on back of 9555 antenna connection
- Ensure 9555 handset is turned off
- Ensure there is no foreign object in the cradle
- Place the 9555 in the cradle with the base in first
- The base connector should line up with the base of the 9555
- Press EJECT button and phone at the same time to securely lock the phone in the docking station.



## Ejecting:

To remove the 9555 handset from the cradle FIRMLY press the "EJECT" button located on the top of the cradle (see diagram).

